

SubConn® Micro Circular

10, 12 and 16 contacts

Connector specifications

Voltage rating	300 V DC/AC rms
Current rating	5 A per contact (max 30 A per connector)
Insulation resistance	> 200 Mohm
Contact resistance	< 0,01 ohm
Wet matings	> 500
Temperature rating (water)	- 4 to 60°C, 25 to 140°F
Temperature rating (air)	- 40 to 60°C, - 40 to 140°F
Storage temperature rating	- 40 to 60°C, - 40 to 140°F
Qualified pressure tested	800 bar, 11,600 psi
Depth rating PEEK	300 bar, 4,350 psi

Material specifications

Connector body	Chloroprene rubber
Bulkhead body	Brass, stainless steel, titanium, anodised aluminium or PEEK
Contacts	Female sockets in gold plated brass UNS - C36000 Male pins in gold plated beryllium copper
O-rings	Nitrile
Locking sleeves	POM or stainless steel
Snap rings	Stainless steel AISI 302
Inline cable (60 cm, 2 ft)	20 AWG 0.52 mm ² chloroprene rubber
Bulkhead leads (30 cm, 1 ft)	20 AWG 0.52 mm ² coloured PTFE

Face view (male)



Inline cable colour code

1 Black	5 Orange	9 Green/black	13 Red/white
2 White	6 Blue	10 Orange/black	14 Green/white
3 Red	7 White/black	11 Blue/black	15 Blue/white
4 Green	8 Red/black	12 Black/white	16 Black/red

Nominal cable outside diameter (OD)

10 conductor cable	0.406", 10.3 mm
12 conductor cable	0.436", 11.0 mm
16 conductor cable	0.472", 12.0 mm

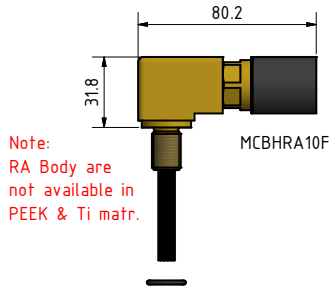
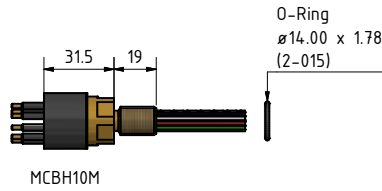
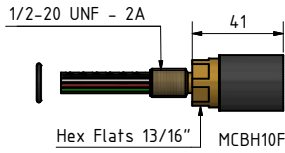
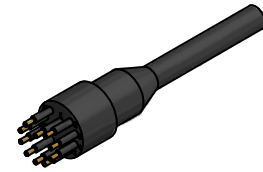
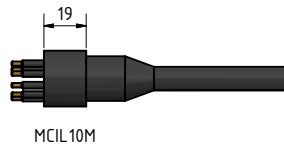
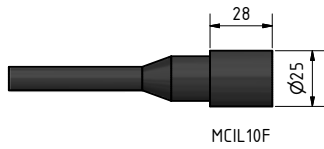

Note:
RA Body are
not available in
PEEK & Ti matr.

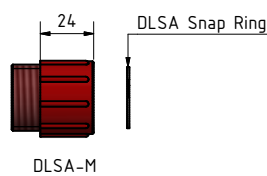
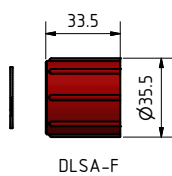
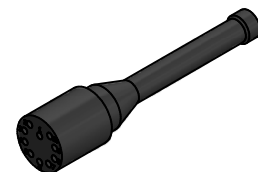
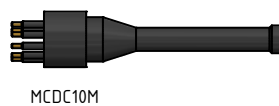
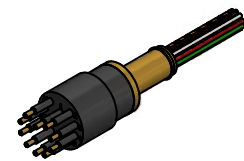
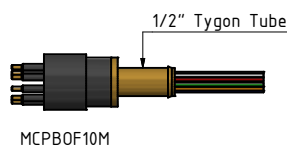
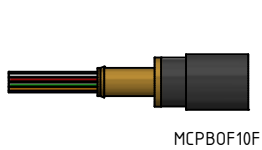
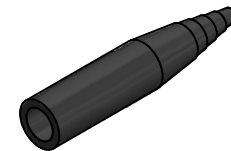
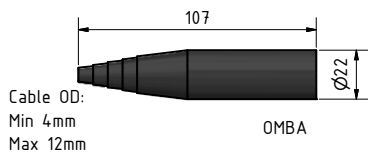
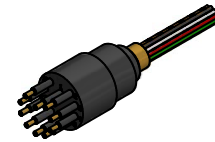
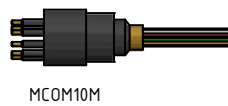
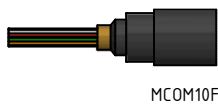
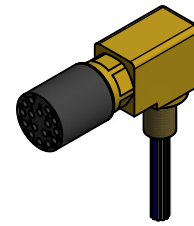
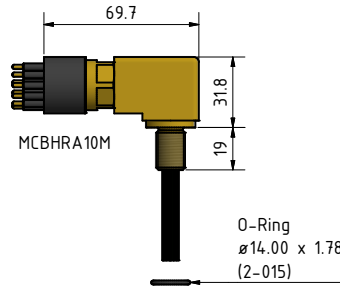

Drawing information

Dimensions in mm (1 mm = 0.03937 inch)
Threads in inches (1 inch = 25.4 mm)